

Bach KLT

Awning protection



Main characteristics

- Weather sensor with radio transmission
- Vibrating device
- Compatible with KLT technology

Specific features

Sensor to detect the oscillations of the structure of the motorised awning.

Affixed directly onto the awning, closing it when necessary.

The value of the oscillations detected can be changed using the dip-switches.

Enables the blind to be reopened half an hour after the alarm signal.

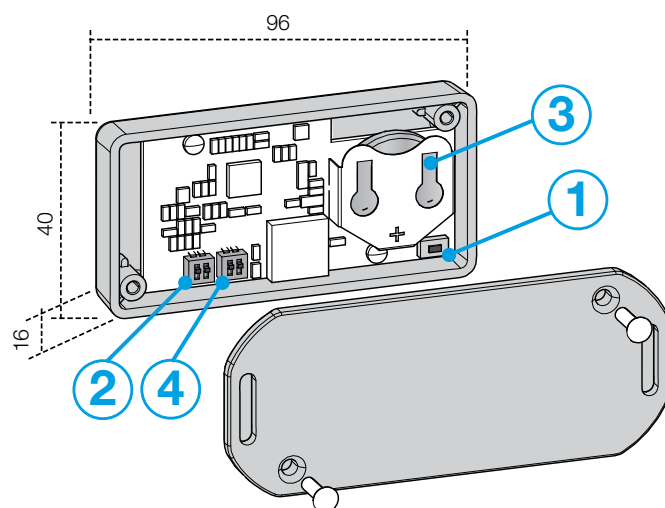

1. Memorisatation button.
2. Dip-switch to set wind sensitivity.
3. Battery
4. Dip-switch for automatic reopening feature.

Bach KLT

Awning protection



KDEP#TENPCA4S112

Example of use

BACH KLT radio-based awning protection device for 1 KLIMT motor.

Motor	1 x KLIMT
Transmitter	1 x WAGNER 1
Sensor	1 x BACH KLT awning protection

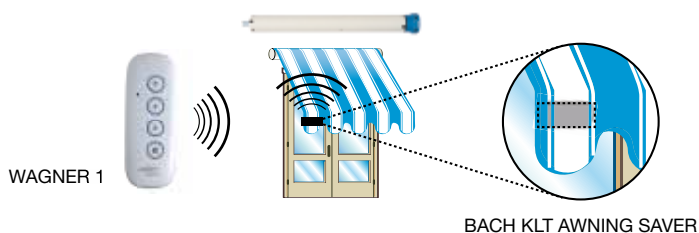

Bach KLT

CODE

001YE0113

Technical information

Power supply	3V CR2450 battery
Frequency (MHz)	433.92
Radio coding	24 bit
Protection rating (IP)	44
Temperature of use (°C)	-20° / +55°
Dimensions (mm)	40 x 96 x 16
Weight (g)	50

PRODUCTS



www.came.com