

# RKLT

Receiving control unit



## Main characteristics

- Stores up to 20 transmitters
- 24 bit
- Person present operating option

## Specific features

Receiving control unit for mechanical motors.

Internal connection terminals for RKLT-50 and RKLT-120 models.

External collection terminals for connection of button for RKLT-W50 model.

### RKLT-50

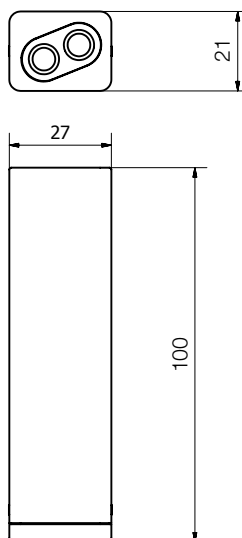

### RKLT-120

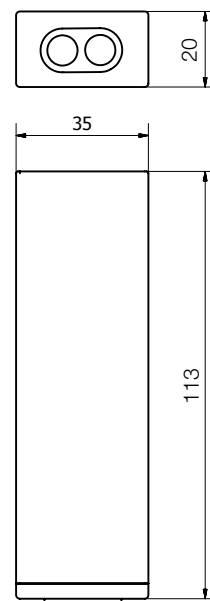

### RKLT-W50

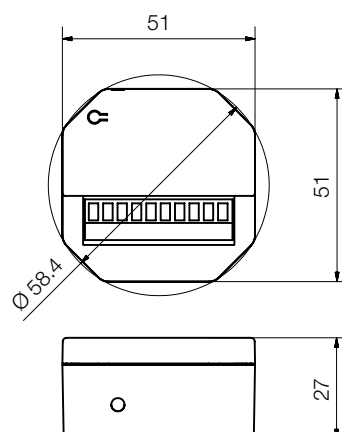

## Specifications

Available on request.

### Example of use

1 x mechanical motor with RKLT-W50 external receiver, button and BACH KLT awning protection.

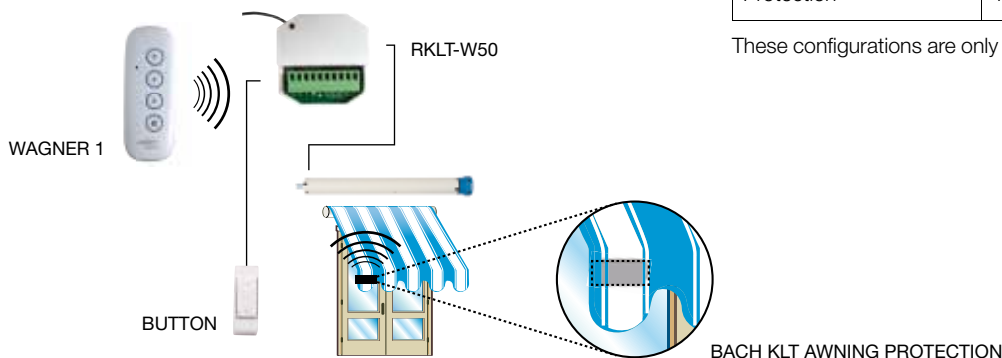

Motor	1 x mechanical motor
Transmitter	1 x WAGNER 1
Receiver	1 x RKLT-W50 receiver
Button	1 x button
Protection	1 x BACH KLT awning protection

These configurations are only possible with 230 V / 50 Hz motors.



### RKLT

CODE	001YE0117	001YE0118	001YE0119
------	-----------	-----------	-----------

### Technical information

	RKLT-50	RKLT-120	RKLT-W50
Power supply (V/Hz)	230 V AC ± 5% 50 Hz	230 V AC ± 5% 50 Hz	230 V AC ± 5% 50 Hz
Maximum power (W)	500	800	500
Frequency (MHz)	433.92	433.92	433.92
Radio coding	24 bit	24 bit	24 bit
Protection rating (IP)	IP 44	IP 44	-
Temperature of use (°C)	-10°C / +55°C	-10°C / +55°C	0°C / +55°C
Dimensions (mm)	100x27x21	113x35x20	51x51x27
Weight (g)	45	60	45

### General description

The RKLT receiving control unit is an electronic module that activates a mechanical motor through transmitters and/or wired commands, equipping the traditional mechanical motor with certain functions typical of the electronic motor.

### Typical uses

- Awnings
- Shutters
- Sun screens